

WHEN DISASSEMBLING ALUMINUM EXTRUSION, TIGHTEN ALL SETSCREWS AND LOCKS TO PREVENT LOSS DURING SHIPPING

visionary™ DESIGNS

Using Your Setup Instructions
The Visionary Designs Setup Instructions are created specifically for your configuration. They are laid out sequentially, including an exploded view of the entire display, and then a logical series of detailed steps to assemble the main structure and components. We encourage you to study the instructions before attempting to assemble your exhibit.

Each page reminds you to tighten the setscrews after disassembling your exhibit to prevent loss of the locks and setscrews (see below in RED). This is VERY IMPORTANT.

Cleaning and Packing Your Display

- 1) Use care when cleaning aluminum extrusion or acrylic inserts. Use only non-abrasive cleaners.
- 2) When cleaning laminate inserts or countertops, use mild cleansers and a soft material such as cotton.
- 3) Keep all display components away from extreme heat and long exposure to sunlight to avoid warping and fading.
- 4) Retain all packing material. It will make re-packing much easier and will reduce the likelihood of shipping damage.



The Tool

Most Visionary Designs exhibits can be assembled with the supplied Hex Key Tool. Occasionally, a flat head screwdriver may be required.



Typical Connection

Most horizontal extrusion connections have a patented expandable lock. This lock inserts into the groove of an opposing extrusion. Tightening the lock with the Hex Key Tool expands the lock and creates a strong positive connection.

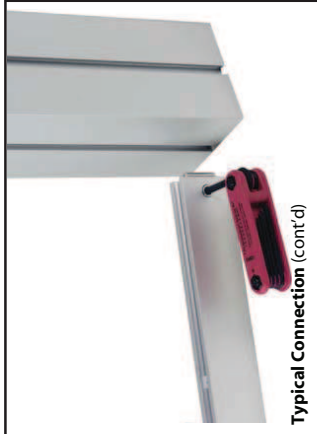

Typical Connection (cont'd)

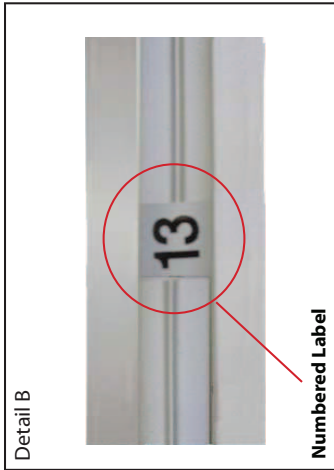

Detail B

Numbered Label

Each extrusion contains a numbered label which corresponds with setup instructions. The label is located within a groove of the extrusion (when possible). With Visionary Designs the labels contain Black numbers unless otherwise specified.



Detail C

Horizontal Inline Connection (remove only one setscrew)

Remove only (1) setscrew when disassembling. Replace setscrew in extrusion after assembling it. Before packing, replace setscrew in extrusion to avoid losing it.

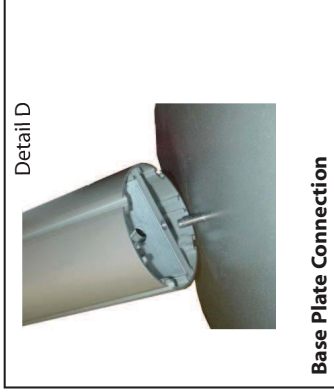

Detail D

Base Plate Connection

Attach base plate to round or square vertical extrusion using the bolt provided. Be careful not to strip the threads.

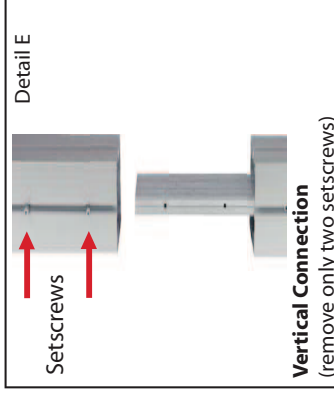

Detail E

Setscrews

Vertical Connection

(remove only two setscrews)

When vertical extrusions are packed in portable cases rather than crates or tubs, they must be broken down into smaller sections which then require assembly.

Remove only (2) setscrews when disassembling. Replace setscrews in extrusion after assembling it. Before packing, replace setscrews in extrusion to avoid losing them.

WHEN DISASSEMBLING ALUMINUM EXTRUSION, TIGHTEN ALL SETSCREWS AND LOCKS TO PREVENT LOSS DURING SHIPPING

866.652.2100

Part Number	Qty for Step	Description
1	2	Base Plates
2	1	96" Vertical extrusion
3	1	96" Vertical extrusion
4	1	96" Lower Horizontal w/ Velcro attached to Top of member
5	1	96" Upper Horizontal w/ Velcro attached to Bottom of member
6	1	92.33" Vertical extrusion

Steps

- 1) Attach vertical extrusions [2 and 3] to base plates [1] referring to Detail D on General Info page.
- 2) Connect horizontal extrusion [4] between vertical extrusions [2 and 3].
- 3) Attach vertical extrusion [6] to center of horizontal extrusion [4] as shown at right.
- 4) Connect upper horizontal extrusion [5] between vertical extrusions [2 and 3] and atop vertical extrusion [6].
- 5) Attach graphic to backwall.

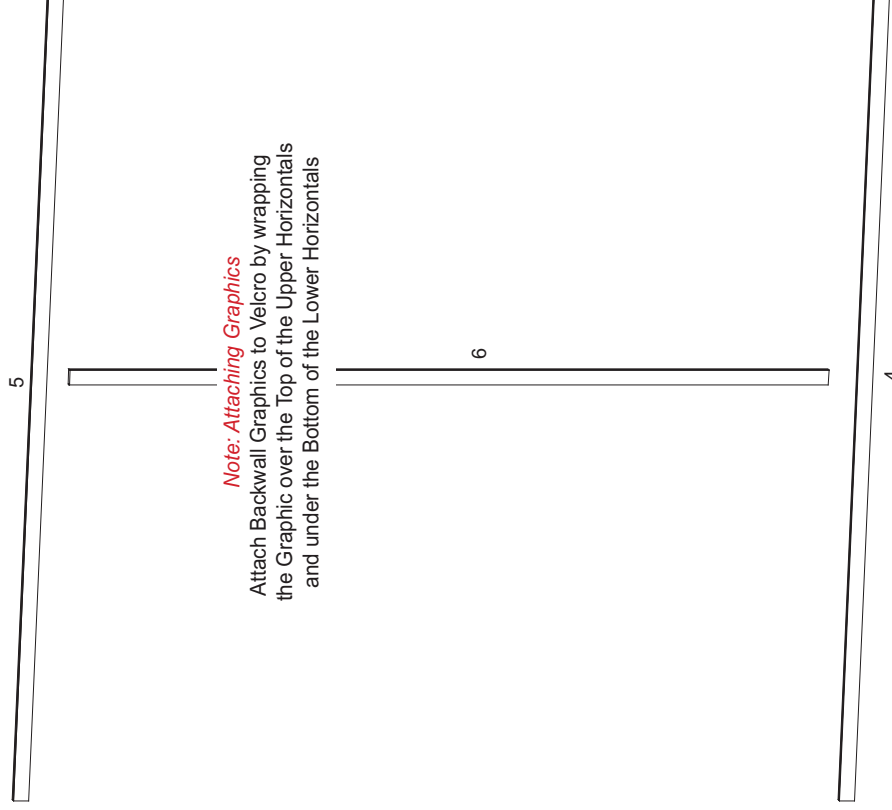
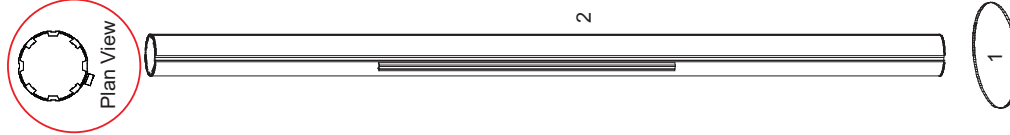

Note: Attaching Graphics
 Attach Backwall Graphics to Velcro by wrapping the Graphic over the Top of the Upper Horizontals and under the Bottom of the Lower Horizontals

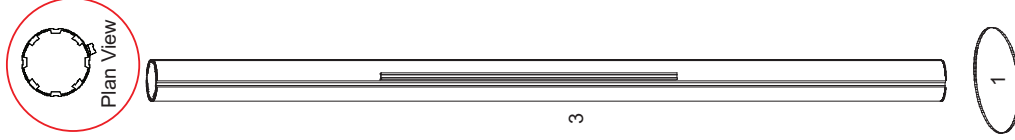

WHEN DISASSEMBLING ALUMINUM EXTRUSION, TIGHTEN ALL SETSCREWS AND LOCKS TO PREVENT LOSS DURING SHIPPING

© 2008

866.652.2100

Part Number	Description
7	25" Horizontal extrusion w/ Velcro attached to Outside Edge
8	25" Horizontal extrusion w/ Velcro attached to Outside Edge
9	98.3097" Curved extrusion w/ Velcro attached to Inside Edge
10	98.3097" Curved extrusion w/ Velcro attached to Inside Edge
11	25" Horizontal extrusion w/ Velcro attached to Outside Edge
12	25" Horizontal extrusion w/ Velcro attached to Outside Edge
13	98.3097" Curved extrusion w/ Velcro attached to Inside Edge
14	98.3097" Curved extrusion w/ Velcro attached to Inside Edge
15	25" Horizontal extrusion w/ Velcro attached to Outside Edge
16	25" Horizontal extrusion w/ Velcro attached to Outside Edge
17	98.3097" Curved extrusion w/ Velcro attached to Inside Edge
18	98.3097" Curved extrusion w/ Velcro attached to Inside Edge

Steps

- 1) Attach horizontal extrusions [7, 8, 11, 12, 15, and 16] between curved vertical extrusions [9, 10, 13, 14, 17, and 18].
(NOTE: Vertical extrusions [13 and 14] have extrusion attachments that are located near the top for Header support)
- 2) Attach graphic to front side of frame.
- 3) Attach perf metal pieces using standoff caps to assembled center frame.
(NOTE: Outer Frames also have holes for standoff connections but upon setup it was realized that it is very difficult to attach all caps)
- 4) Hook Assembled Frames over Backwall.

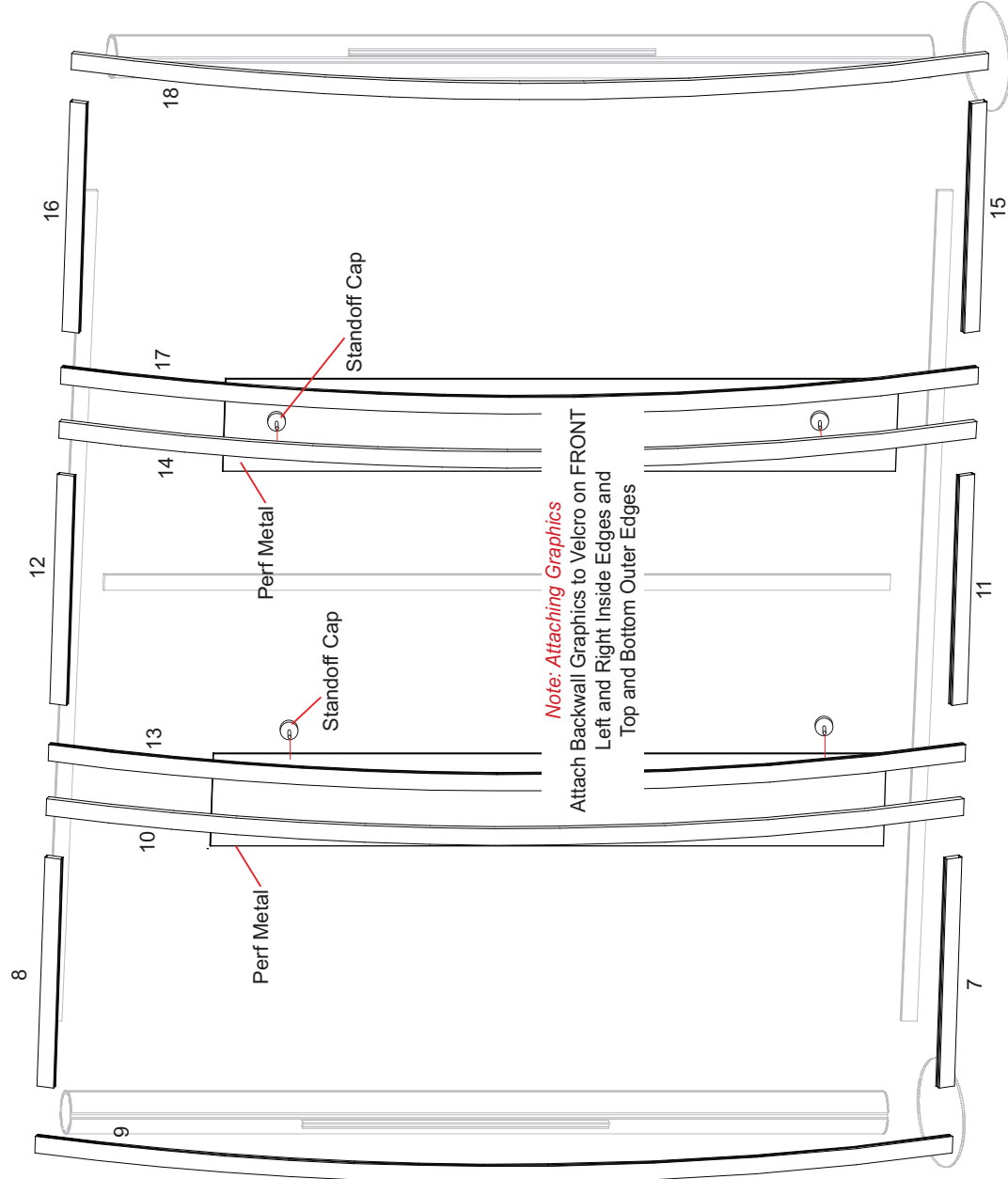
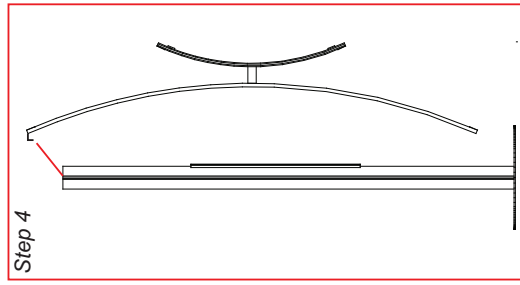

WHEN DISASSEMBLING ALUMINUM EXTRUSION, TIGHTEN ALL SETSCREWS AND LOCKS TO PREVENT LOSS DURING SHIPPING

866.652.2100

Part Number	Description
19	25" Horizontal extrusion w/ Steel Tape on Outer Edge
20	25" Horizontal extrusion w/ Steel Tape on Outer Edge
21	41.0499" Curved extrusion w/ Steel Tape on Outer Edge
22	41.0499" Curved extrusion w/ Steel Tape on Outer Edge
23	25" Horizontal extrusion w/ Steel Tape on Outer Edge
24	25" Horizontal extrusion w/ Steel Tape on Outer Edge
25	41.0499" Curved extrusion w/ Steel Tape on Outer Edge
26	41.0499" Curved extrusion w/ Steel Tape on Outer Edge
27	25" Horizontal extrusion w/ Steel Tape on Outer Edge
28	25" Horizontal extrusion w/ Steel Tape on Outer Edge
29	41.0499" Curved extrusion w/ Steel Tape on Outer Edge
30	41.0499" Curved extrusion w/ Steel Tape on Outer Edge
31	3.5" Horizontal Extrusion

Steps

- 1) Attach horizontal extrusions [19, 20, 23, 24, 27, and 28] between curved vertical extrusions [21, 22, 25, 26, 29, and 30].
- 2) Attach assembled small frames to larger curved frames using extrusion [31] and connecting to the center attachment on both.
- 3) Attach graphic to front side of frame.
- 4) Attach standoff caps to assembled frames.

(NOTE: Outer Frames also have holes for standoff connections but upon setup it was realized that it is very difficult to attach all caps)

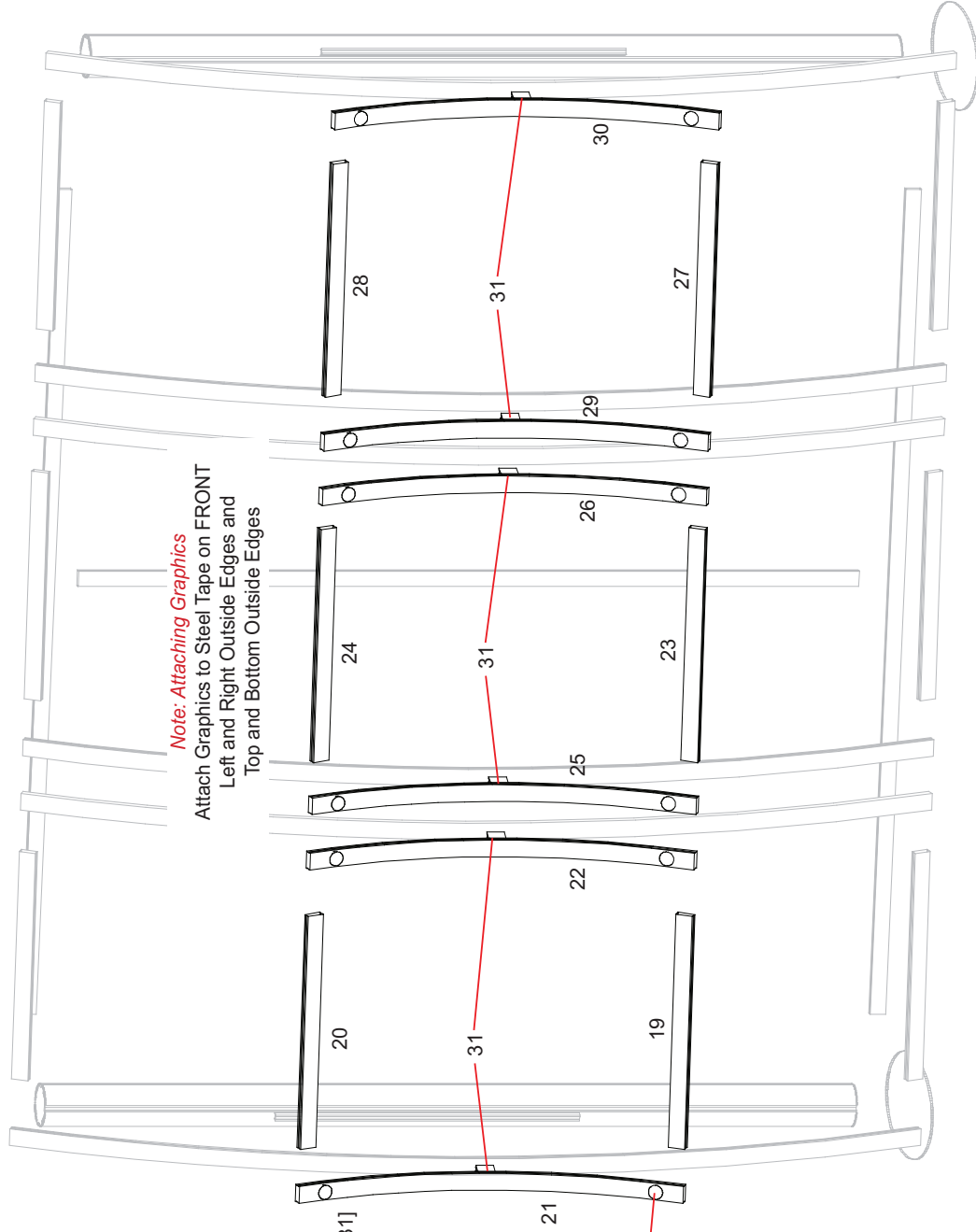
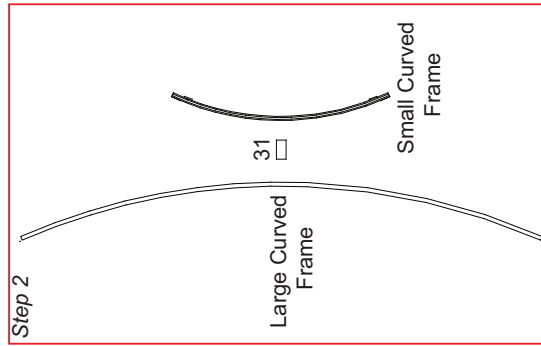

Note: Attaching Graphics
Attach Graphics to Steel Tape on FRONT
Left and Right Outside Edges and
Top and Bottom Outside Edges

WHEN DISASSEMBLING ALUMINUM EXTRUSION, TIGHTEN ALL SETSCREWS AND LOCKS TO PREVENT LOSS DURING SHIPPING

866.652.2100

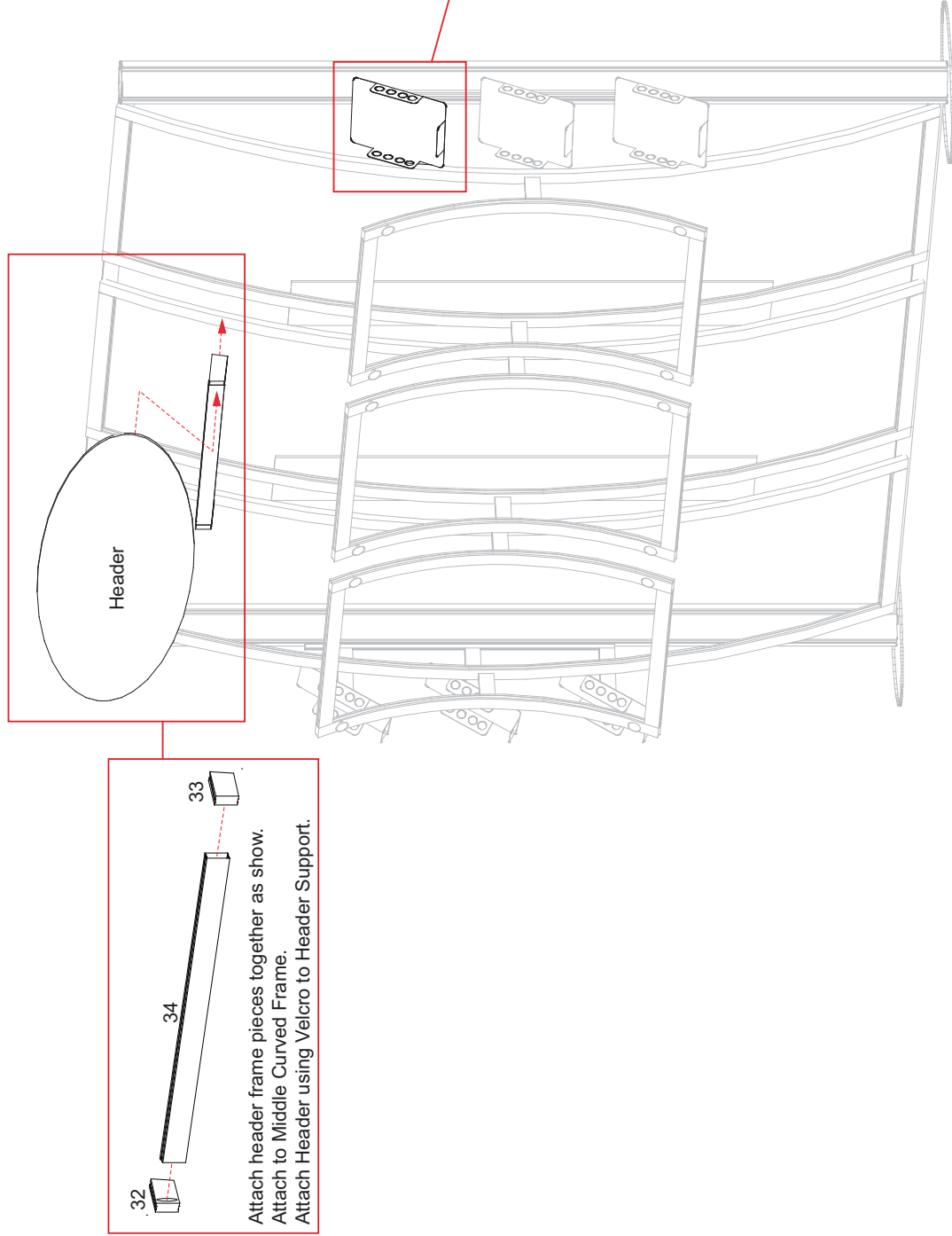

32

33

34

Attach header frame pieces together as show.
Attach to Middle Curved Frame.
Attach Header using Velcro to Header Support.

Literature Rack Attachment

Tighten Lock to Secure

Attach connector piece to rack as shown. Then connect assembled literature rack to vertical extrusion.

WHEN DISASSEMBLING ALUMINUM EXTRUSION, TIGHTEN ALL SETSCREWS AND LOCKS TO PREVENT LOSS DURING SHIPPING

866.652.2100

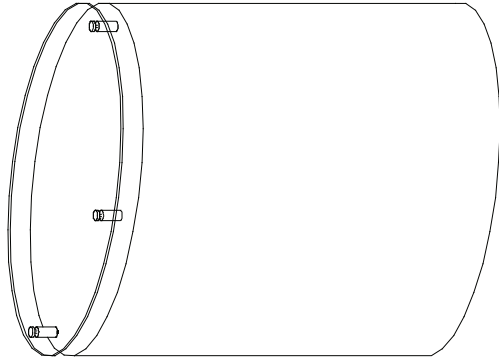

Top View

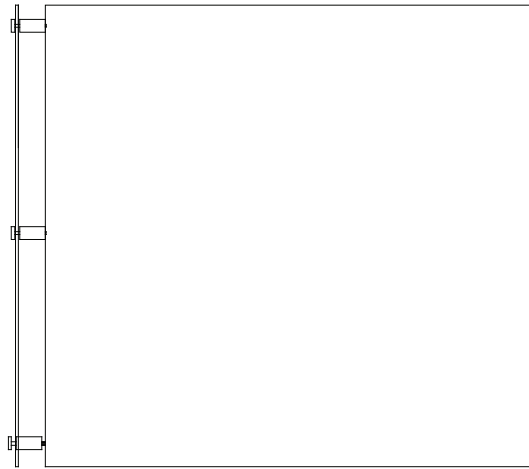

Front View

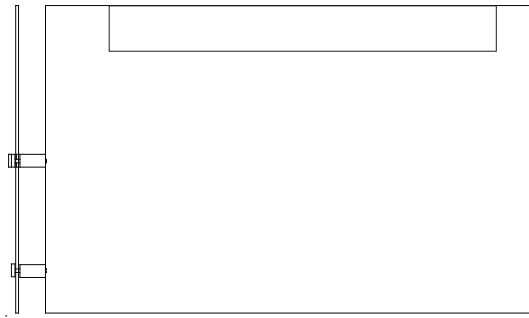

Back View

WHEN DISASSEMBLING ALUMINUM EXTRUSION, TIGHTEN ALL SETSCREWS AND LOCKS TO PREVENT LOSS DURING SHIPPING

© 2008

866.652.2100

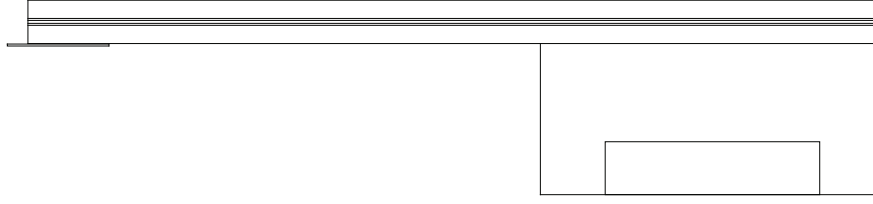
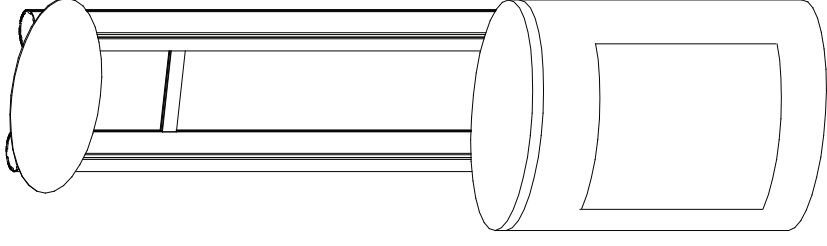

Back View

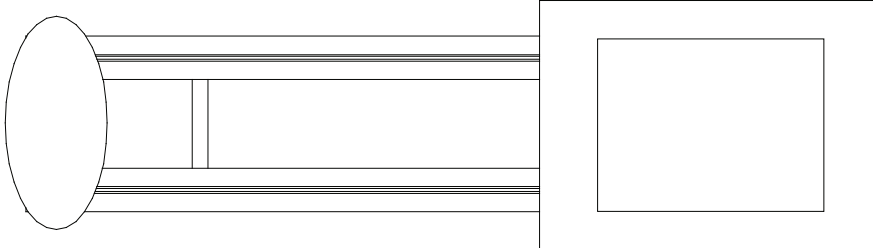

Front View

WHEN DISASSEMBLING ALUMINUM EXTRUSION, TIGHTEN ALL SETSCREWS AND LOCKS TO PREVENT LOSS DURING SHIPPING

© 2008